

Appendices

Kent College, Pembury—Major Developed Site within the Metropolitan Green Belt

not to scale

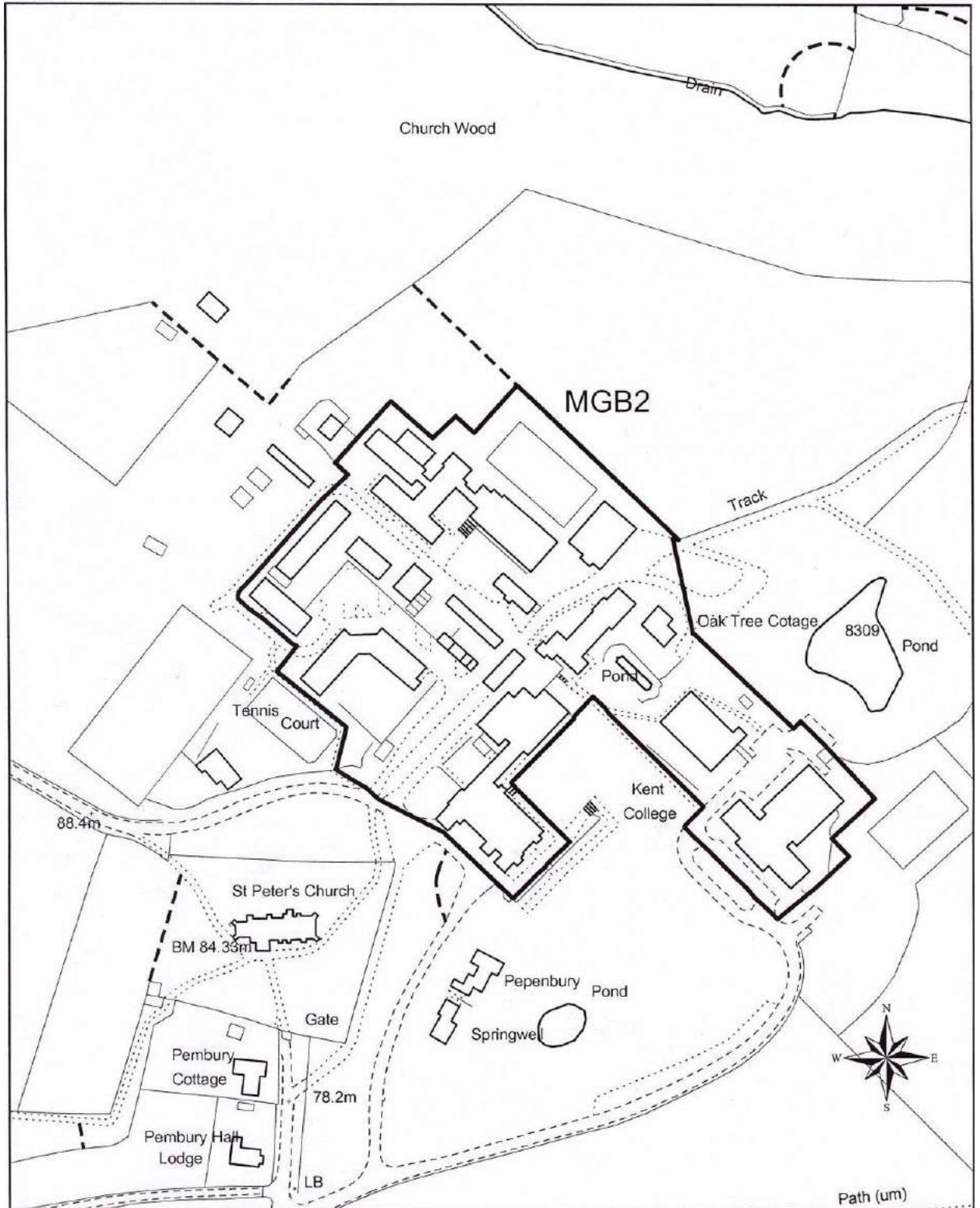

Reproduced from Ordnance Survey material with the permission of Ordnance Survey on behalf of the Controller of Her Majesty's Stationery Office © Crown copyright. Unauthorised reproduction infringes Crown copyright and may lead to prosecution or civil proceedings. Tunbridge Wells Borough Council 100024298, 2006

Area of Special Control for Advertisements

Scale – 1:40,000

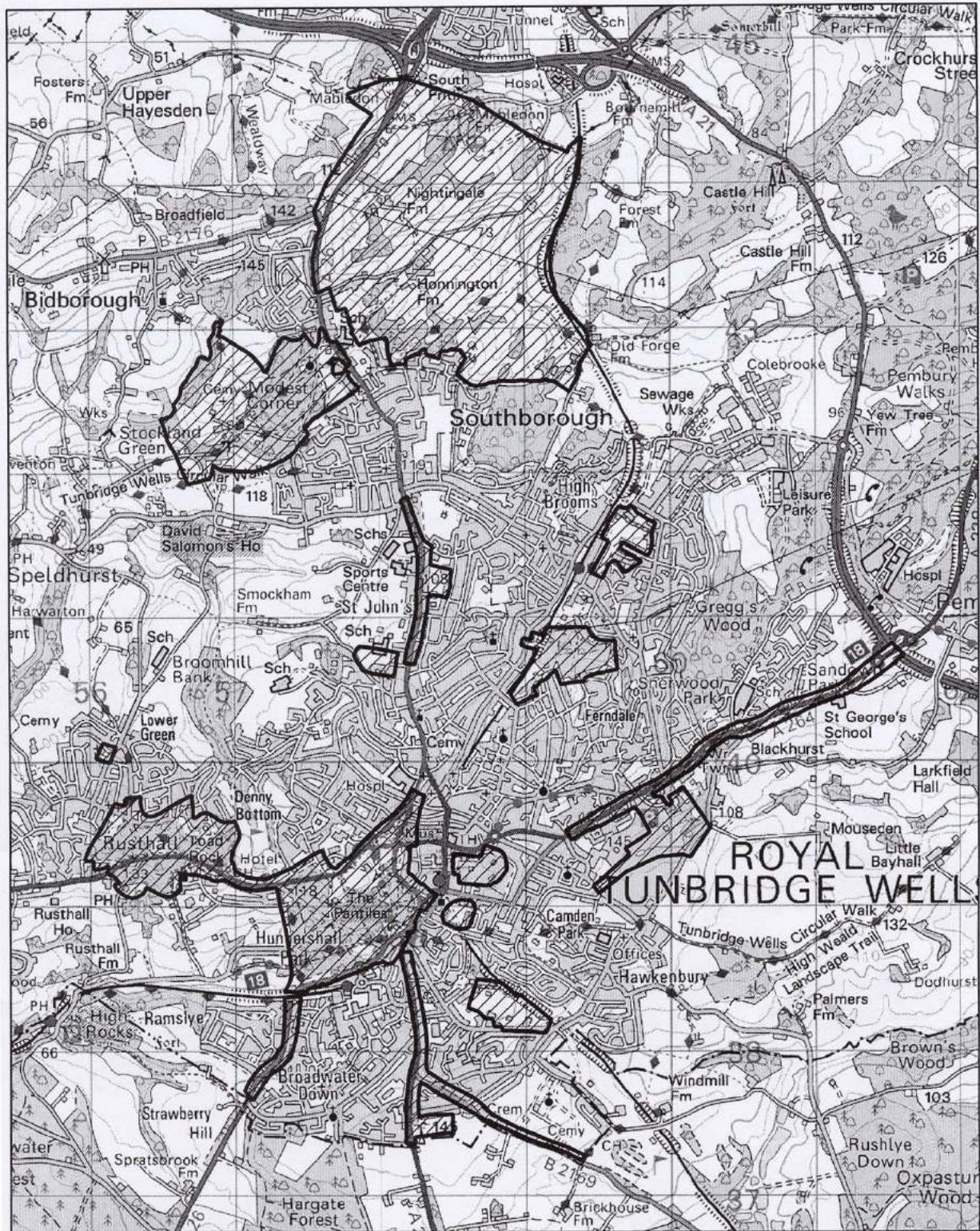

Reproduced from Ordnance Survey material with the permission of Ordnance Survey on behalf of the Controller of Her Majesty's Stationery Office © Crown copyright. Unauthorised reproduction infringes Crown copyright and may lead to prosecution or civil proceedings. Tunbridge Wells Borough Council 100024298, 2006

Scheduled Ancient Monuments

Scheduled Ancient Monuments		
	Location	Description
Royal Tunbridge Wells	High Rocks	Earthworks, Iron Age Hill Fort
Royal Tunbridge Wells	Moat Farm	Medieval Moated Site
Cranbrook	Little Farningham Wood	Roman Site
Cranbrook	Bedgebury Furnace	Tudor Iron Furnace
Benenden	Iden Green	Paved Ford crossing line of Roman Road
Brenchley	Castle Wood Castle	Iron Age Hill Fort
Capel	Castle Hill	Earthworks, Iron Age Hill Fort
Horsmonden	Moated Site	Share Farm
Lamberhurst	Scotney Castle	Medieval and later Castle
Speldhurst	Groombridge Place	Medieval Moated Site

Nature Conservation Areas/Historic Parks and Gardens

Nature Conservation Areas				Historic Parks and Gardens	
Town/Parish	Sites of Special Scientific Interest	Sites of Nature Conservation Interest	Sites of Local Nature Conservation Value	Parks and Gardens of Special Historic Interest (Historic Buildings & Monuments)	Historic Parks and Gardens
Royal Tunbridge Wells	Rusthall Common High Rocks	Benhall Mill Road/Forest Road Pasture, woodland and Hawkenbury Bog TW22 Friezland Wood TW23 Gregg's Wood TW45 High Wood, Hawkenbury TW21 Broomhill and Reynolds Lane Pastures and Hurst Wood TW46 Rusthall Common, inc. St Paul's Churchyard, and Tunbridge Wells Common TW24	Calverley Park Great Culverden Park Hurst Wood Nellington Wood, Rusthall Ram Wood Reynolds Lane Woodland Woodbury Park Cemetery	Calverley Park and Grounds Dunorlan Park Woodbury Park Cemetery	Blackhurst*
Southborough	Southborough Pit	Brokes and Bameetts Wood TW25 Southborough Common TW27 Southborough Cemetery TW28 Vauxhall Lane Woods TW50	Bameetts Wood, High Brooms	Mableton	
Paddock Wood			Church Road (woodland)		
Cranbrook	Robins Wood Sissinghurst Park Wood	Roundshill Park Wood, Sissinghurst TW3 Angley Wood TW4 Bedgebury Forest TW8	Crane Valley Recreation Ground	Sissinghurst Court Sissinghurst Castle Hartridge House (Sissinghurst Park)	Glassenbury Park Sissinghurst Castle Wilsley* Angley House*
Benenden	Parsonage Wood	Benenden Churchyard TW29 Benenden Wood TW38 Beston Farm Pasture & Orchard TW41 Hemsted Forest TW1 Moor Wood, Iden Green TW31 Nine Acre Wood & Gill TW33 Sandpit Wood, Clapper Hill TW2 White Chimney Wood TW13 Ashour Wood TW37		Benenden School	Hemsted Park (Benenden School) Hole Park The Grange*
Bidborough		Bidborough Woods & Pasture TW26 St Lawrence's Churchyard TW43		Swaylands	
Brenchley		All Saints' Churchyard TW39 Brenchley Wood TW16 Castle Hill Wood and Pasture TW15 Shirrenden Woods Park and Pond TW34 Petteridge grassland & ponds TW52			Bratties Grange* Brenchley Manor* Crittenden House Marle Place*
Capel		East Tonbridge copses & dykes TW20 Somershill Park TW19 Tudeley Woods TW18		Somershill Park	The Postern

Nature Conservation Areas				Historic Parks and Gardens	
Town/Parish	Sites of Special Scientific Interest	Sites of Nature Conservation Interest	Sites of Local Nature Conservation Value	Parks and Gardens of Special Historic Interest (Historic Buildings & Monuments)	Historic Parks and Gardens
Frittenden		Brick Pit Wood TW40 The Cemetery TW53 Leggs Wood TW55	Churchyard		
Goudhurst	Combwell Wood	Bedgebury Forest TW8 Bedgebury Park School TW7 Chingley Wood TW10 Goudhurst Pasture TW6 Old Park Wood, Iden Green TW5	Kildown Churchyard Kildown Pond and surrounds	Bedgebury Pinetum	Bedgebury Park Bedgebury Pinetum Finchcocks Glassenbury Park Ladham House * Scotney Castle
Hawkhurst		Bedgebury Forest TW8 Bokes Farm TW54 Collingwood, The Moor TW42 St Laurence's Churchyard TW35 White Chimney Wood TW13	All Saints Pond St Laurence's Churchyard		Bedgebury Park Bedgebury Pinetum Lillesden
Horsmonden		Horsmonden Churchyard TW14 Shirrenden Wood & Pond TW34			Rectory Park Sprivers
Lamberhurst	Scotney Castle Brookland Wood	Bayham Woods TW48 Old Swan Farm, Lamberhurst Quarter TW11 Woods, River Teise TW12	Lamberhurst Down	Bayham Abbey Scotney Castle	The Owl House Scotney Castle
Pembury	Pembury Cutting & Pit	Bayham Woods TW48 Brenchley Wood TW16 Pembury Walks TW17 St Peter's old churchyard TW51			
Sandhurst		Dowgate Wood, Four Throws TW30 St Nicholas's Churchyard TW49	Sandhurst Pond		
Speldhurst		Avery's Wood, Bullingstone TW36 Priest Wood, Langton Green TW32 St Mary's Churchyard TW44		Groombridge Place	Groombridge Place Ashurst Park/Place * Broomlands Danemore Park

* These gardens do not appear in the Kent Gardens Compendium but have appeared in the schedule and in some cases the Proposals Map since 1996.

Royal Tunbridge Wells Primary Shopping Area – Character Areas

Character Area 1 – Royal Victoria Place/Ely Court – not to scale

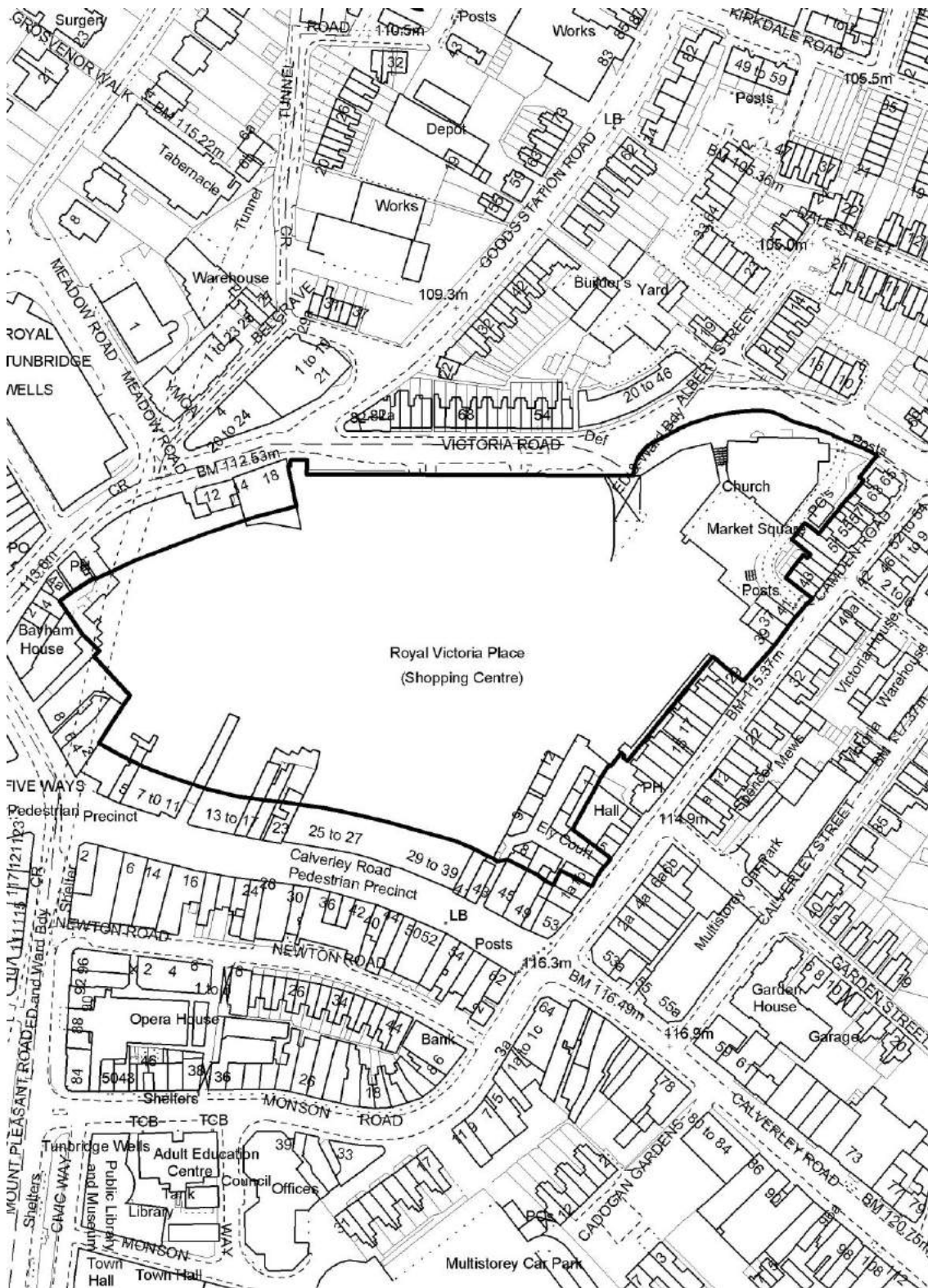

Reproduced from Ordnance Survey material with the permission of Ordnance Survey on behalf of the Controller of Her Majesty's Stationery Office © Crown copyright. Unauthorised reproduction infringes Crown copyright and may lead to prosecution or civil proceedings. Tunbridge Wells Borough Council 100024298, 2006

Royal Tunbridge Wells Primary Shopping Area – Character Areas

Character Area 2 – Calverley Road (west) – not to scale

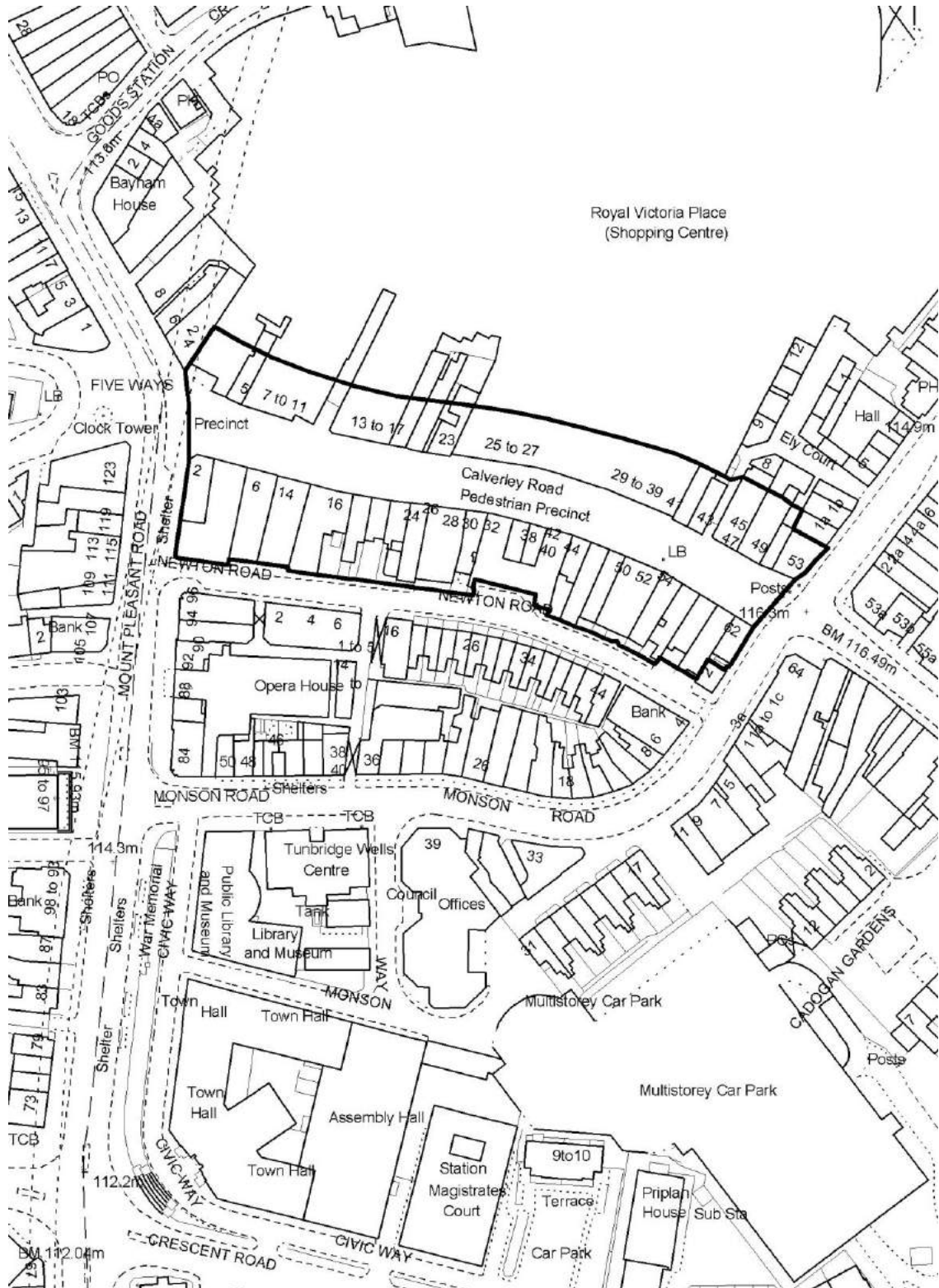

Reproduced from Ordnance Survey material with the permission of Ordnance Survey on behalf of the Controller of Her Majesty's Stationery Office © Crown copyright. Unauthorised reproduction infringes Crown copyright and may lead to prosecution or civil proceedings. Tunbridge Wells Borough Council 100024298, 2006

Royal Tunbridge Wells Primary Shopping Area – Character Areas

Character Area 3 – Monson Road/Camden Road – not to scale

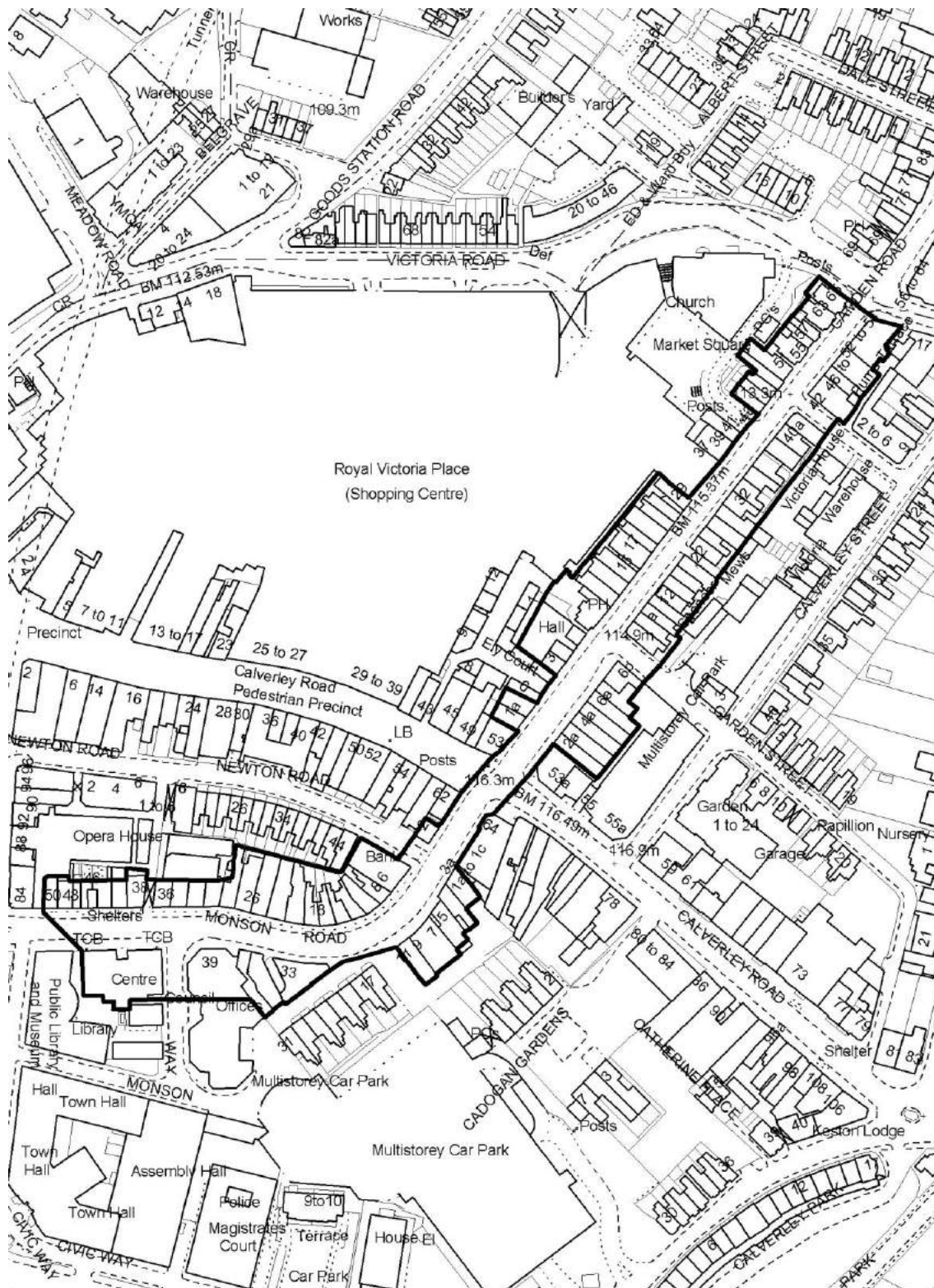

Reproduced from Ordnance Survey material with the permission of Ordnance Survey on behalf of the Controller of Her Majesty's Stationery Office © Crown copyright. Unauthorised reproduction infringes Crown copyright and may lead to prosecution or civil proceedings. Tunbridge Wells Borough Council 100024298, 2006

Royal Tunbridge Wells Primary Shopping Area – Character Areas

Character Area 4 – Calverley Road (east) – not to scale

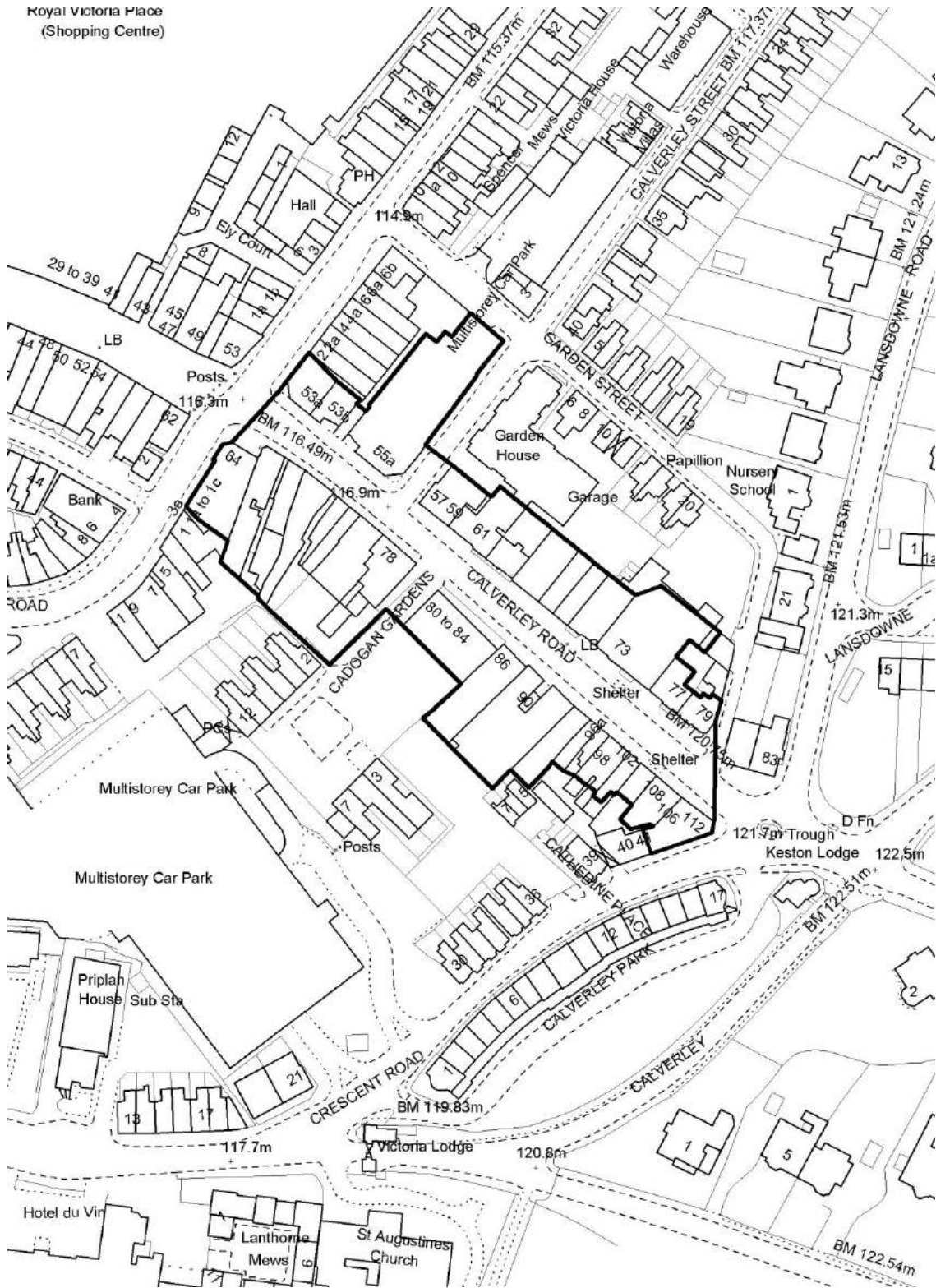

Reproduced from Ordnance Survey material with the permission of Ordnance Survey on behalf of the Controller of Her Majesty's Stationery Office © Crown copyright. Unauthorised reproduction infringes Crown copyright and may lead to prosecution or civil proceedings. Tunbridge Wells Borough Council 100024298, 2006

Royal Tunbridge Wells Primary Shopping Area – Character Areas

Character Area 5 – Goods Station Road/Grosvenor Road – not to scale

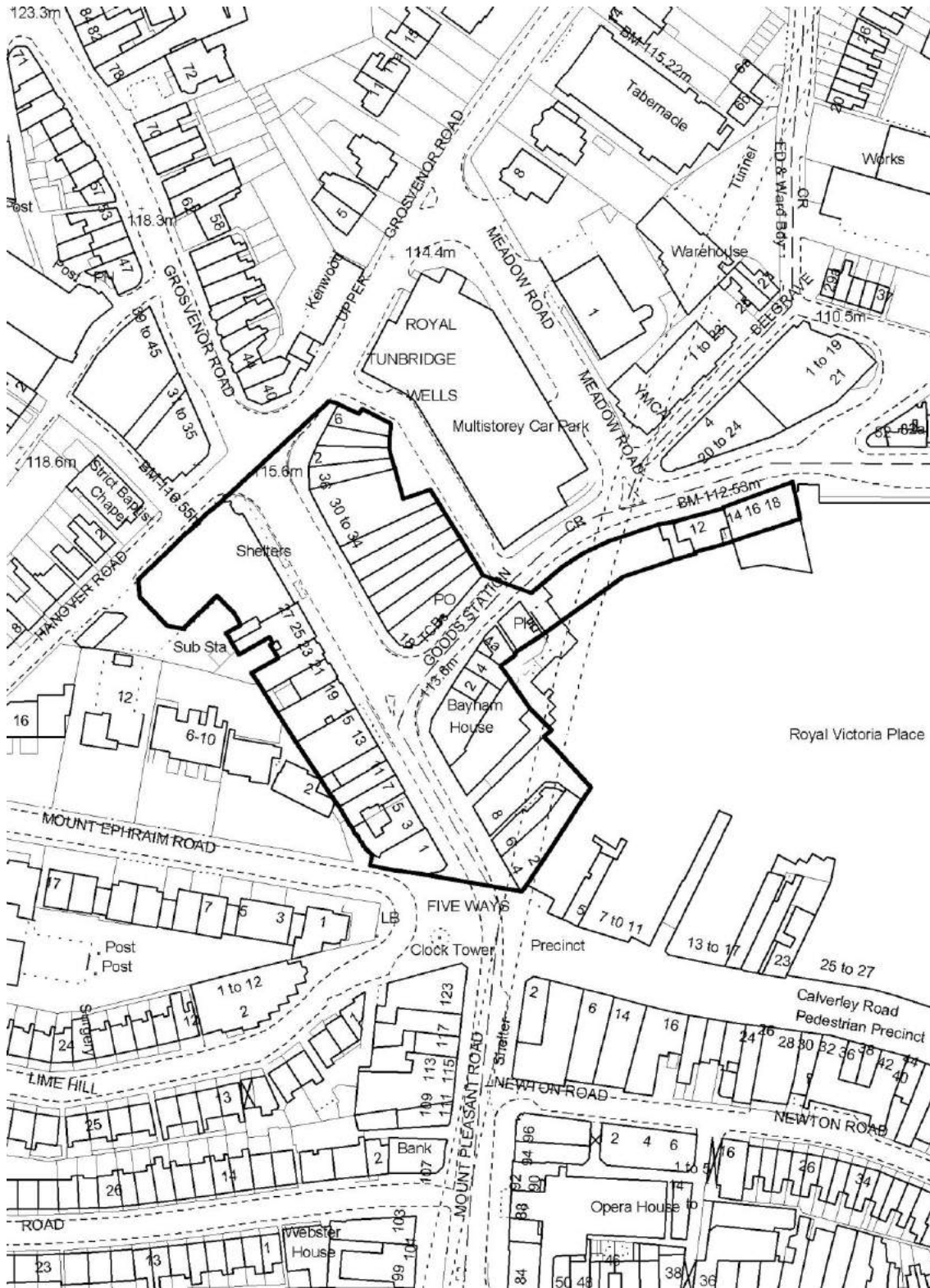

Reproduced from Ordnance Survey material with the permission of Ordnance Survey on behalf of the Controller of Her Majesty's Stationery Office © Crown copyright. Unauthorised reproduction infringes Crown copyright and may lead to prosecution or civil proceedings. Tunbridge Wells Borough Council 100024298, 2006

Royal Tunbridge Wells Primary Shopping Area – Character Areas

Character Area 6 – Mount Pleasant Road (north) – not to scale

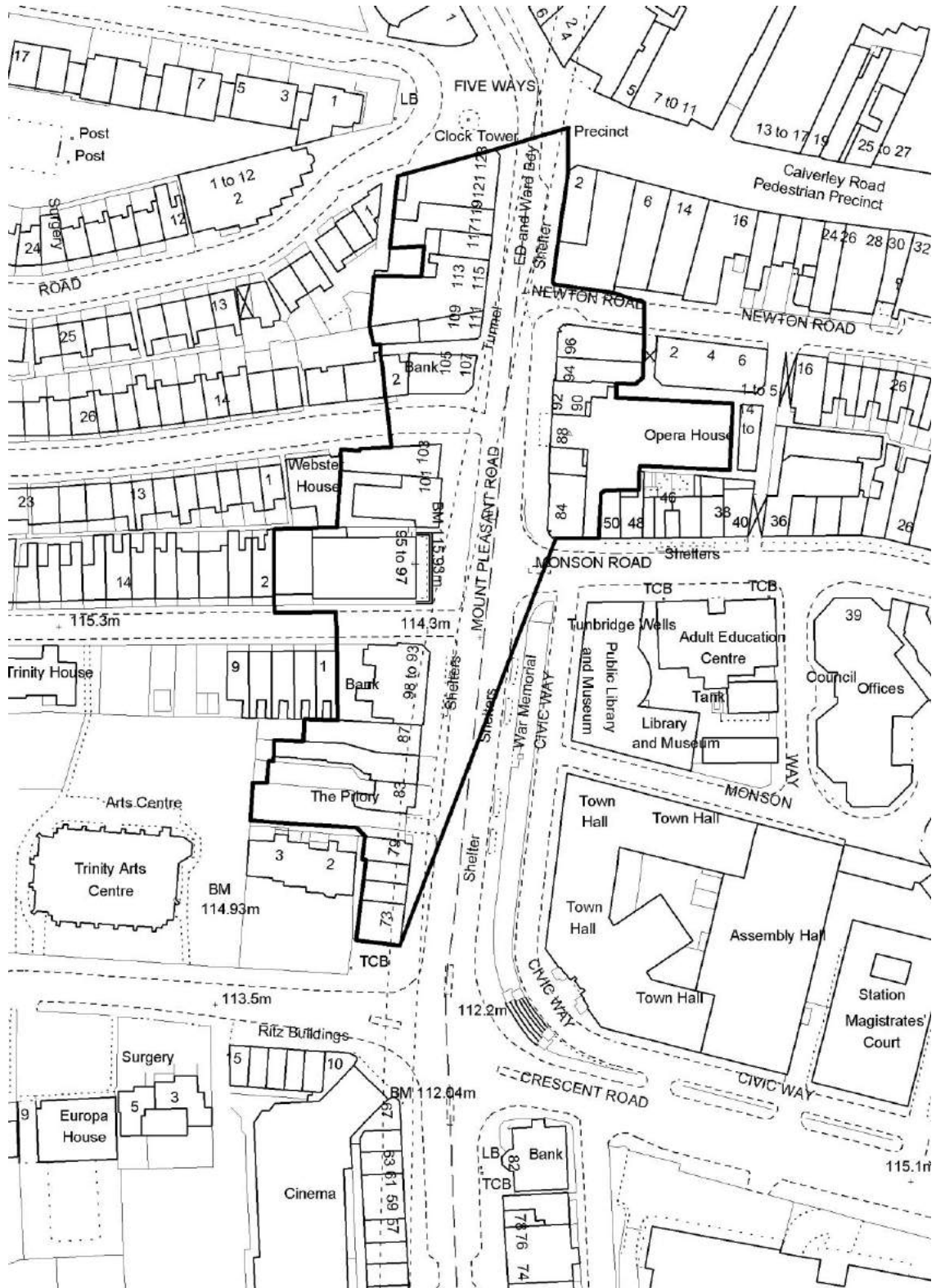

Reproduced from Ordnance Survey material with the permission of Ordnance Survey on behalf of the Controller of Her Majesty's Stationery Office © Crown copyright. Unauthorised reproduction infringes Crown copyright and may lead to prosecution or civil proceedings. Tunbridge Wells Borough Council 100024298, 2006

Royal Tunbridge Wells Primary Shopping Area – Character Areas

Character Area 7 – Mount Pleasant Road (south) – not to scale

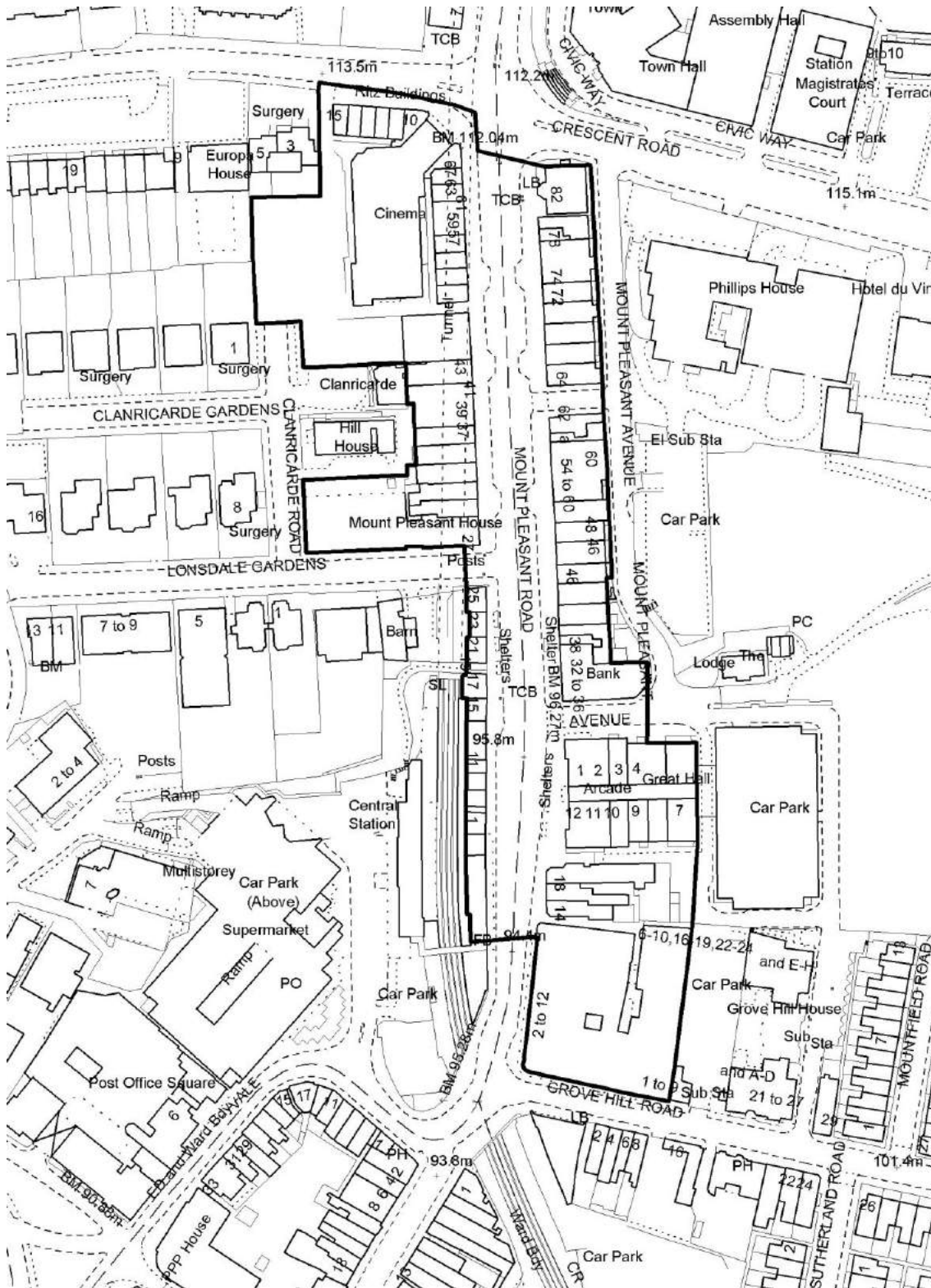

Reproduced from Ordnance Survey material with the permission of Ordnance Survey on behalf of the Controller of Her Majesty's Stationery Office © Crown copyright. Unauthorised reproduction infringes Crown copyright and may lead to prosecution or civil proceedings. Tunbridge Wells Borough Council 100024298, 2006

Royal Tunbridge Wells Primary Shopping Area – Character Areas

Character Area 8 – Vale Road/Grove Hill Road – not to scale

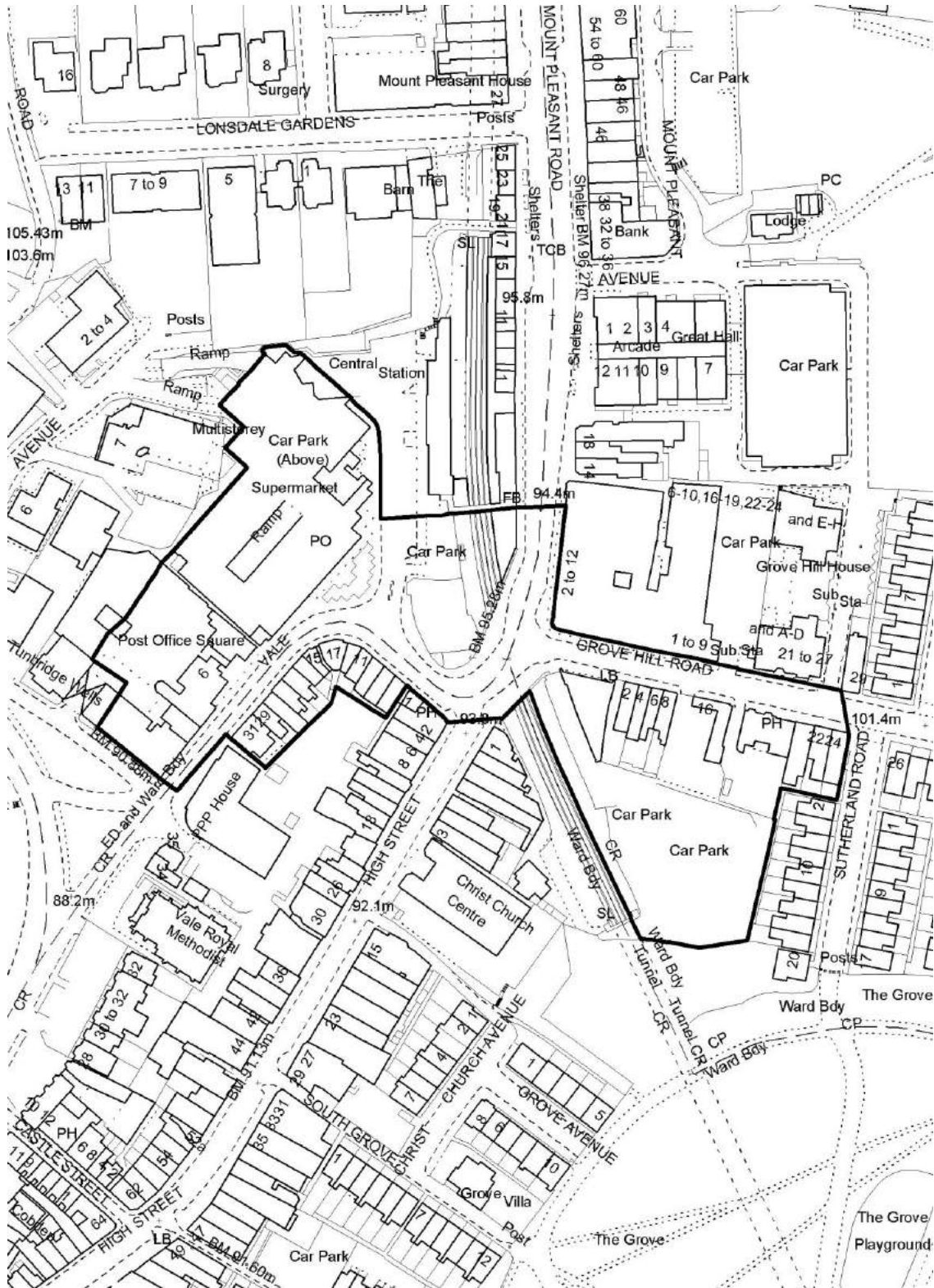

Reproduced from Ordnance Survey material with the permission of Ordnance Survey on behalf of the Controller of Her Majesty's Stationery Office © Crown copyright. Unauthorised reproduction infringes Crown copyright and may lead to prosecution or civil proceedings. Tunbridge Wells Borough Council 100024298, 2006

Royal Tunbridge Wells Primary Shopping Area – Character Areas

Character Area 9 – High Street/Castle Street/Chapel Place – not to scale

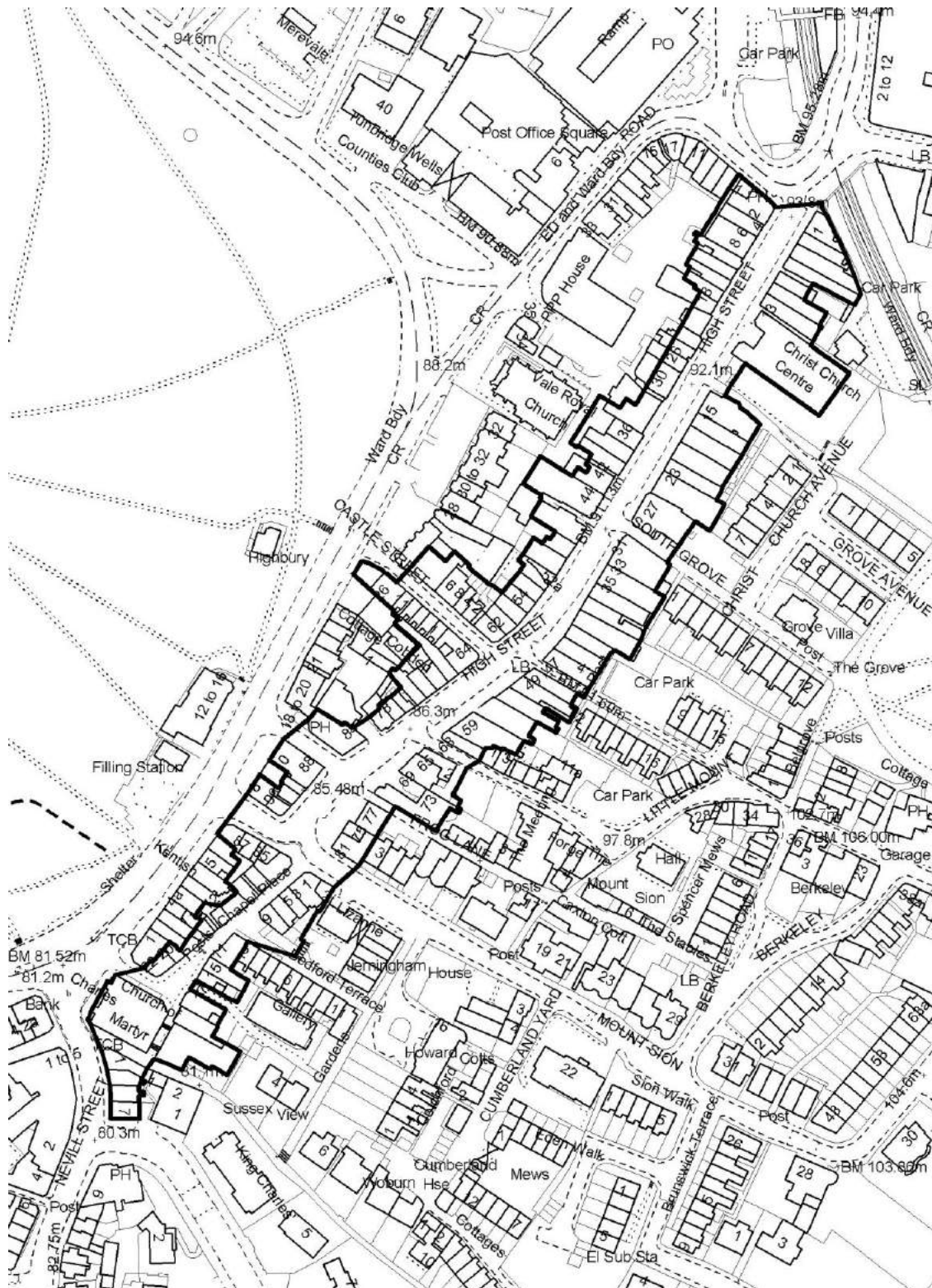

Reproduced from Ordnance Survey material with the permission of Ordnance Survey on behalf of the Controller of Her Majesty's Stationery Office © Crown copyright. Unauthorised reproduction infringes Crown copyright and may lead to prosecution or civil proceedings. Tunbridge Wells Borough Council 100024298, 2006

Royal Tunbridge Wells Primary Shopping Area – Character Areas

Character Area 10 – The Pantiles/Union Square – not to scale

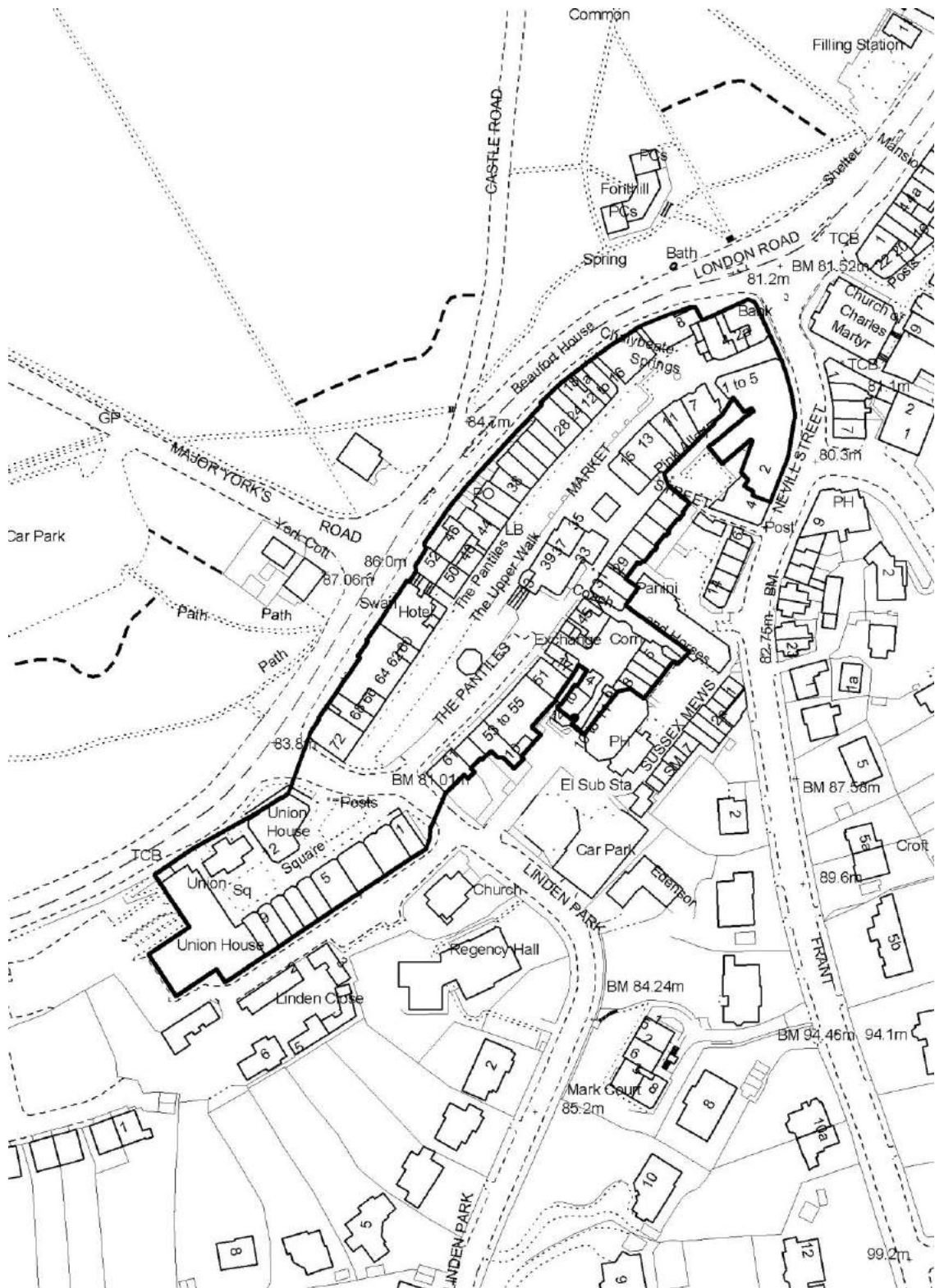

Reproduced from Ordnance Survey material with the permission of Ordnance Survey on behalf of the Controller of Her Majesty's Stationery Office © Crown copyright. Unauthorised reproduction infringes Crown copyright and may lead to prosecution or civil proceedings. Tunbridge Wells Borough Council 100024298, 2006

Road Hierarchy

A. Inter-Urban Hierarchy

(i) PRIMARY ROUTES

The preferred route linking urban centres of more than 25,000 population and passing within 5 miles of those centres and having no physical restrictions. These are already identified in the approved Kent Structure Plan (e.g. motorways, trunk roads, primary 'A' roads).

(ii) SECONDARY ROUTES

The preferred route linking urban centres of 10,000 to 25,000 population, located within 5 miles of those centres and having no physical restrictions. Routes passing through a number of smaller settlements may also justify this classification if the traffic flow exceeds 5,000 vehicles per day. Roads parallel to motorways and giving an alternative route should also be secondary routes (e.g. other 'A' roads).

(iii) LOCAL ROUTES

Routes linking urban centres of 3,000 to 10,000 population with each other and with the primary/secondary route network (e.g. 'B' and 'C' roads).

(iv) ACCESS ROUTES

Routes giving access to routes above them in the hierarchy.

B. Urban Hierarchy

In assessing proposals for development the Local Planning Authority will take account of the road hierarchy based on the functions of the routes as set out in the following classification:

A) PRIMARY DISTRIBUTORS

These roads form the primary network for the towns and villages as a whole. Where capacity exists, all longer-distance traffic to, from and within the towns and villages should be channelled onto the primary distributors.

B) DISTRICT DISTRIBUTORS

These roads carry traffic from primary distributors to the residential and business districts of the towns and villages and distribute traffic between districts.

C) LOCAL DISTRIBUTORS

These roads distribute traffic within residential, industrial and business areas. They form the link between District Distributors and Access Roads.

D) ACCESS ROADS

These roads give direct access to buildings and land within residential, industrial and business areas and include privately-owned access roads.

The Road Hierarchy

ROYAL TUNBRIDGE WELLS AND SOUTHBOROUGH

1. Primary Distributors

A26

A264 (including Calverley Park Gardens, Crescent Road, Church Road, Mount Ephraim (between Church Road and Major York's Road), Bishop's Down, Langton Road, Mount Ephraim (between Church Road and Grosvenor Road))

A267 (Frant Road)

2. District Distributors

Bayhall Road

Bayham Road

Bidborough Ridge

Birling Road (from Frant Road to Bayham Road)

Calverley Road (between Carrs Corner and Prospect Road)

Dowding Way (following construction of North Farm/High Brooms Link Road)

Forest Road

Garden Road

Goods Station Road (between Grosvenor Road and Victoria Road to be renamed Victoria Road)

Grosvenor Road

Grove Hill Road

High Brooms Road

Highfield Road

Longfield Road

Major York's Road

Meadow Road

Mount Pleasant Road

Pembury Road (between Calverley Park Gardens and Prospect Road)

Prospect Road

Sandhurst Road

Sandrock Road

Upper Grosvenor Road

Vale Road

Victoria Road

Yew Tree Road

3. Local Distributors

Birken Road

Bishop's Down Park Road (between Molyneux Park Road and Culverden Down)

Broadmead

Broadmead Avenue

Broadwater Down

Broadwater Lane (from Eridge Road to Showfields Road)

Broadwater Rise (from Broadmead to Broadwater Down)

Broomhill Road

Calverley Road (part only)

Camden Road

Church Road, Constitutional Hill Road, Kibbles Lane, Southborough

Claremont Road

Culverden Down (from Culverden Park to Bishop's Down Park Road)

Culverden Park

Ferndale

Greggswood Road

Grosvenor Bridge

Lamberts Road

Lansdowne Road

Liptraps Lane (between Lamberts Road and Birken Road)
 Lower Green Road
 Molyneux Park Road
 Monson Road
 Mount Sion
 Nevill Terrace
 North Farm Lane (between North Farm Road and Lamberts Road)
 North Farm Road
 Powder Mill Lane (between A26 and Yew Tree Road)
 Quarry Road
 Rusthall High Street
 Rusthall Road
 Sherwood Road
 Showfields Road
 Speldhurst Road
 St James Road
 Woodbury Park Road

Road Hierarchy – Settlements Outside Royal Tunbridge Wells

Parish	Primary	Distributor	
		District	Local
Ashurst	Ashurst Road Ashurst Hill	–	–
Benenden	–	The Street	New Pond Road
Bidborough	–	Bidborough Ridge	–
Brenchley	–	–	High Street Horsmonden Road Windmill Hill
Cranbrook	Angley Road –	High Street Stone Street Waterloo Road –	Bakers Cross Carriers Road (part) Oakfield Drive St David's Bridge The Hill
Five Oak Green	–	Five Oak Green Road	–
Frittenden	–	–	Cranbrook Road Biddenden Road Mill Lane

Parish	Primary	Distributor	
		District	Local
Goudhurst	Church Road Clay Hill High Street The Plain West Road Cranbrook Road	Balcombes Hill Chequers Lane North Road –	– –
Hawkhurst	Cranbrook Road High Street Highgate Hill Horns Road Moor Hill Rye Road The Moor	– –	– –
Horsmonden	–	Lamberhurst Road Maidstone Road	Brenchley Road Goudhurst Road
Kilndown	–	–	Chicks Lane Church Lane Raners Lane Rogers Rough Road
Lamberhurst	School Hill Spray Hill The Broadway	High Street Town Hill –	–
Langton Green	Langton Road	–	–
Matfield	–	Maidstone Road –	Brenchley Road Chestnut Lane
Paddock Wood	–	Badsell Road Maidstone Road –	Church Road Mascalls Court Road Station Road Warrington Road
Pembury	–	Hastings Road High Street Lower Green Road Maidstone Road	Henwood Green Road –
Sandhurst	Queen Street –	–	Back Lane Bodiam Road
Sissinghurst	The Street	Common Road	–

Access Roads

All roads within the Plan area and not identified in the above are considered access roads.

Land Reserved for Car Parking at Ashurst Station, Ashurst, Speldhurst

Scale – 1:2,500

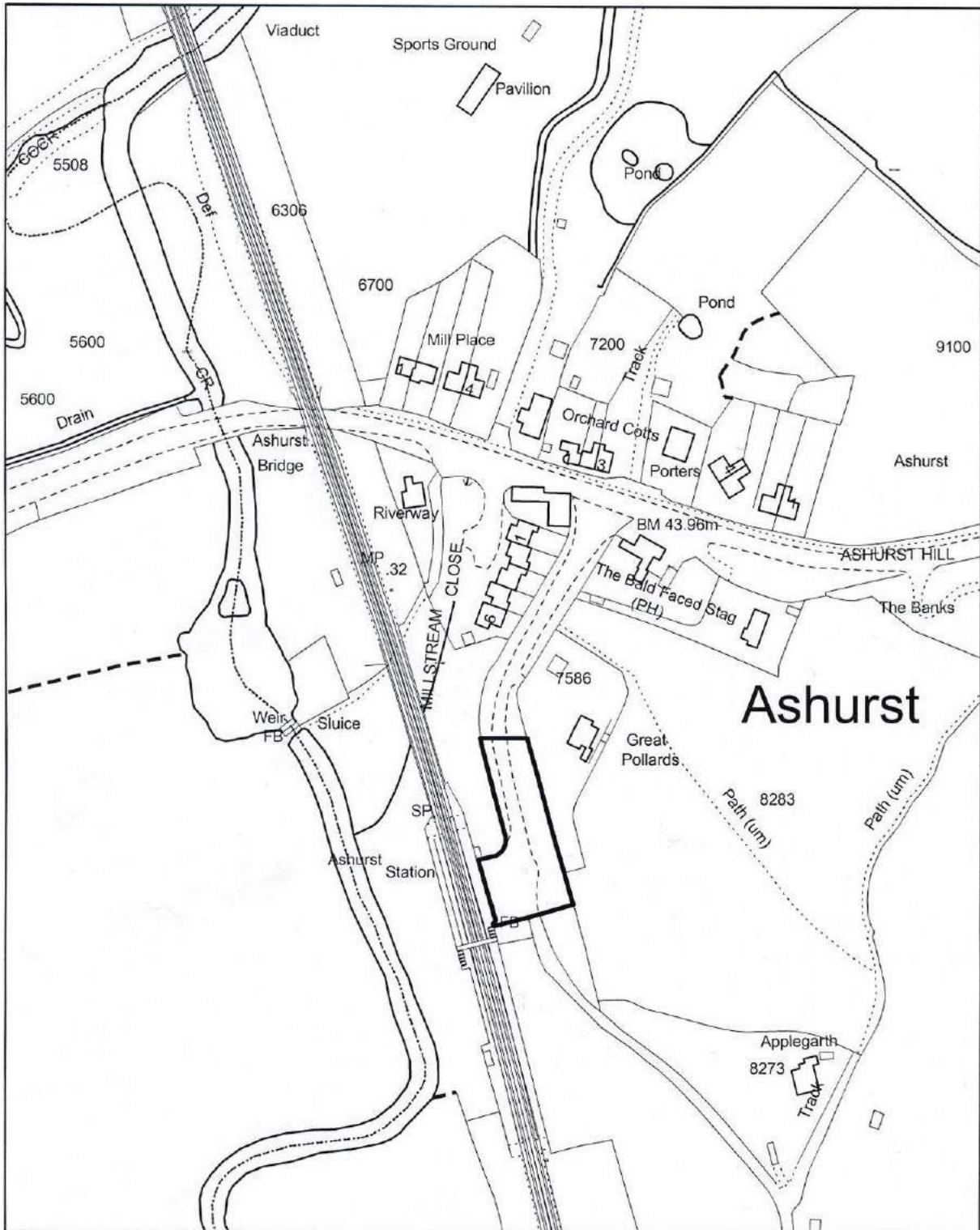

Reproduced from Ordnance Survey material with the permission of Ordnance Survey on behalf of the Controller of Her Majesty's Stationery Office © Crown copyright. Unauthorised reproduction infringes Crown copyright and may lead to prosecution or civil proceedings. Tunbridge Wells Borough Council 100024298, 2006

Highway Improvements – detail of the A26 London Road, Southborough, loading and short stay parking bays and cycle/pedestrian crossing facilities: Policy TP19(a)

Scale 1:500

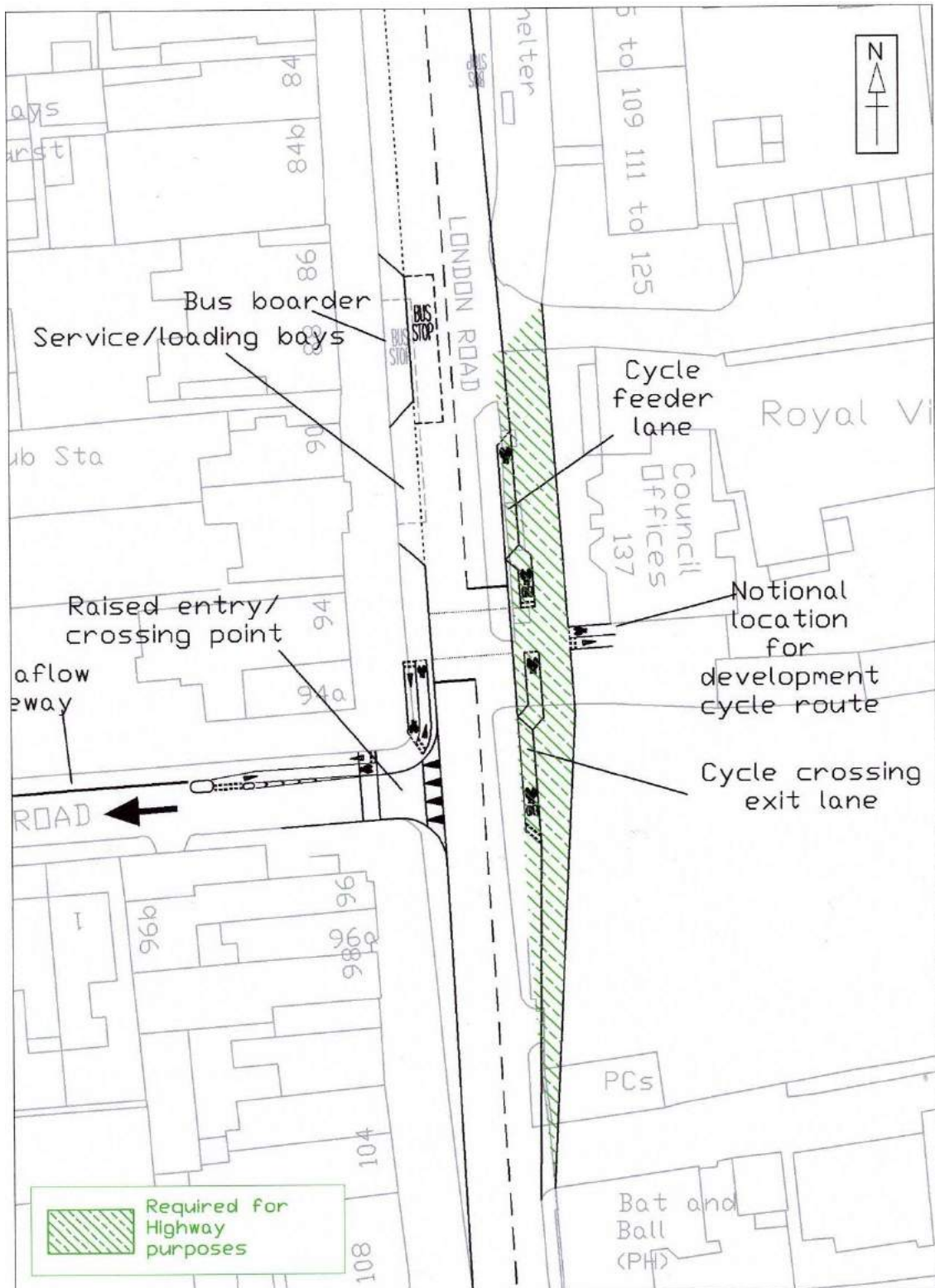

Reproduced from Ordnance Survey material with the permission of Ordnance Survey on behalf of the Controller of Her Majesty's Stationery Office © Crown copyright. Unauthorised reproduction infringes Crown copyright and may lead to prosecution or civil proceedings. Tunbridge Wells Borough Council 100024298, 2006

Highway Improvements – detail of the A26 between John Street and Culverden Park, southbound bus priority measures: Policy TP19(b)

Scale 1:1,250

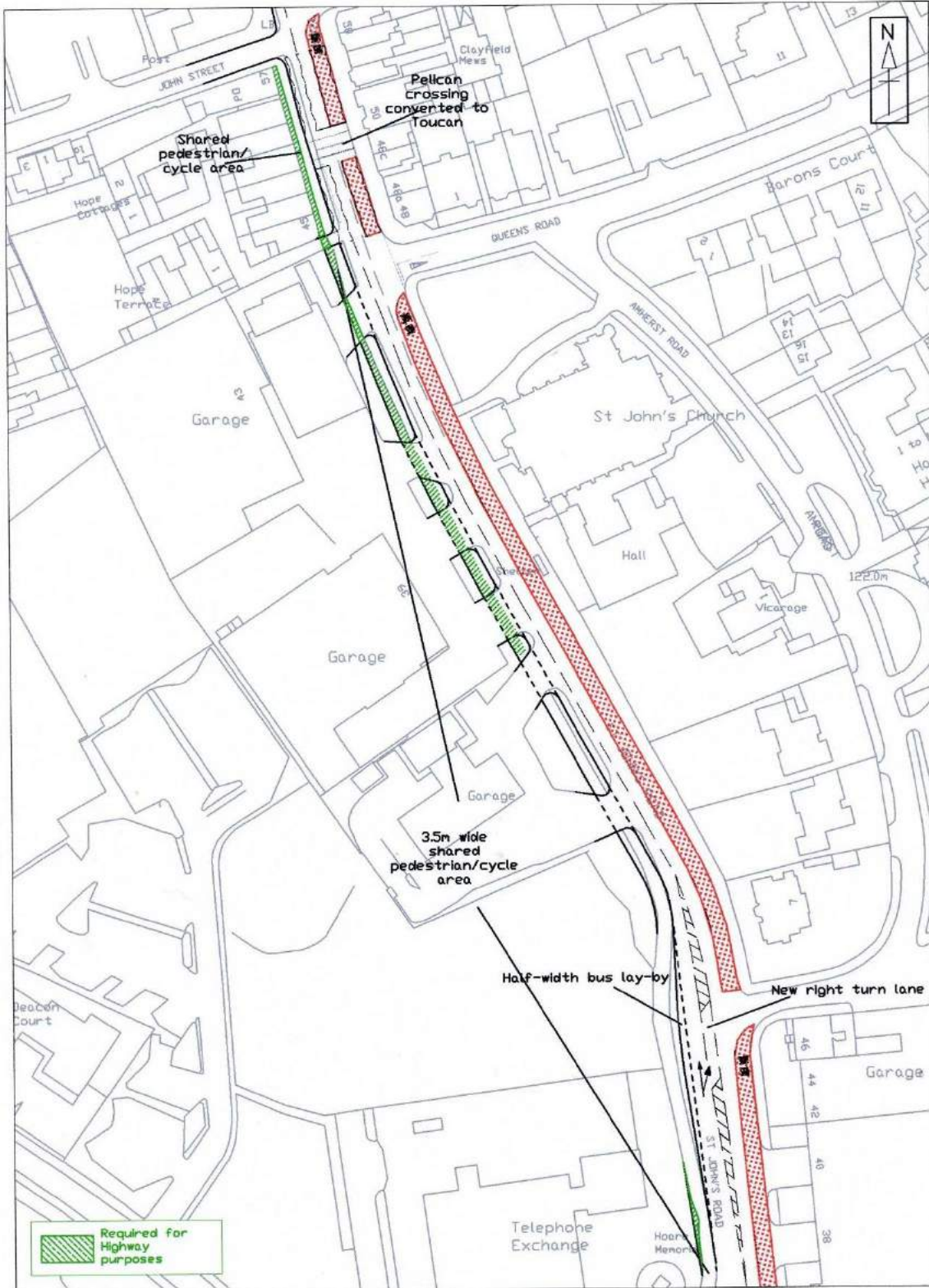

Reproduced from Ordnance Survey material with the permission of Ordnance Survey on behalf of the Controller of Her Majesty's Stationery Office © Crown copyright. Unauthorised reproduction infringes Crown copyright and may lead to prosecution or civil proceedings. Tunbridge Wells Borough Council 100024298, 2006

Highway Improvements – detail of the A26 London Road/Vale Road junction improvements: Policy TP19(c)

Scale 1:500

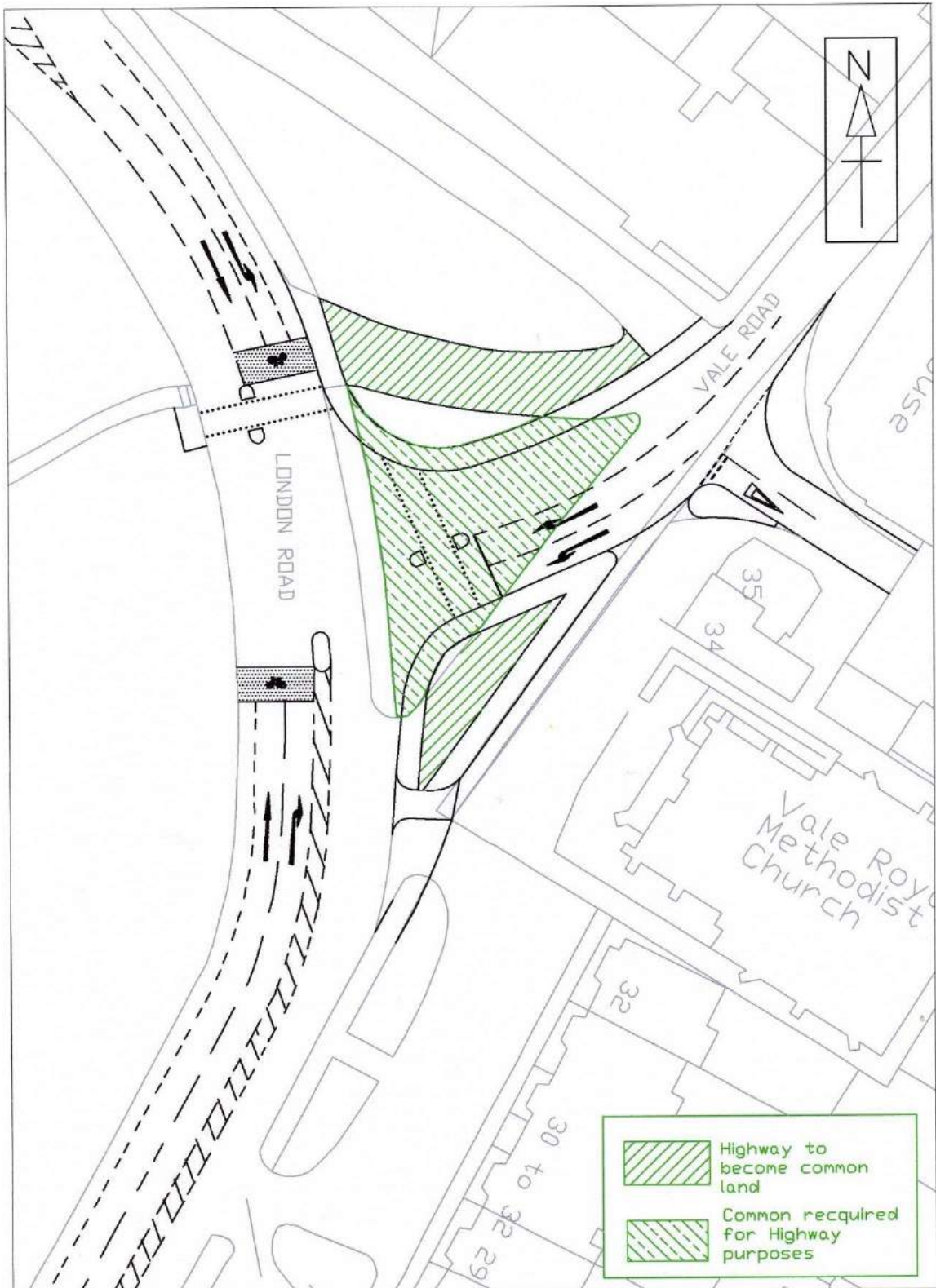

Reproduced from Ordnance Survey material with the permission of Ordnance Survey on behalf of the Controller of Her Majesty's Stationery Office © Crown copyright. Unauthorised reproduction infringes Crown copyright and may lead to prosecution or civil proceedings. Tunbridge Wells Borough Council 100024298, 2006

Highway Improvements – detail of the A264 Langton Road/Coach Road junction improvements: Policy TP19(d)

Scale 1:500

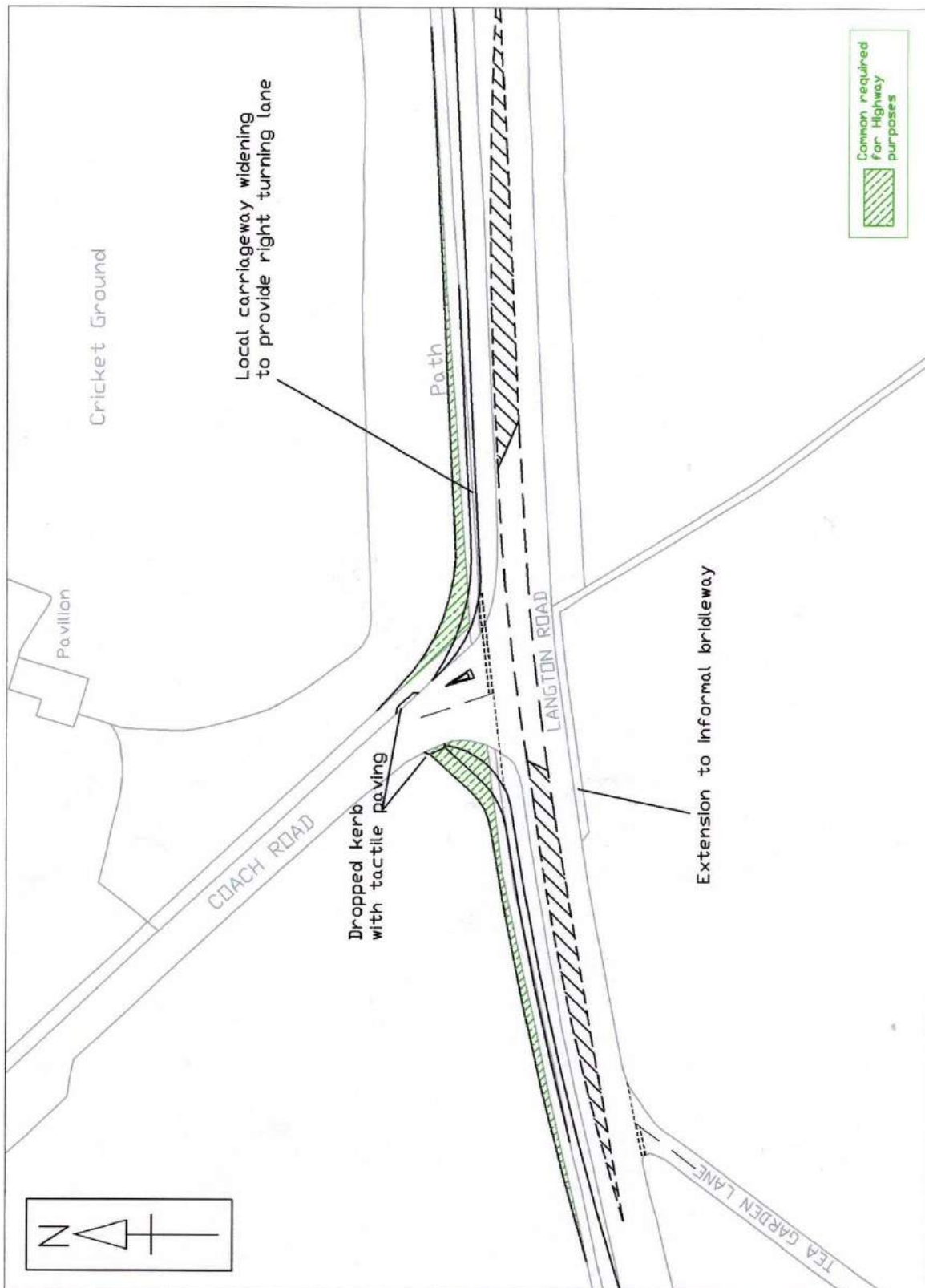

Reproduced from Ordnance Survey material with the permission of Ordnance Survey on behalf of the Controller of Her Majesty's Stationery Office © Crown copyright. Unauthorised reproduction infringes Crown copyright and may lead to prosecution or civil proceedings. Tunbridge Wells Borough Council 100024298, 2006

Highway Improvements – detail of the A264 Langton Road loading and short stay parking bays: Policy TP19(e)

Scale 1:750



Reproduced from Ordnance Survey material with the permission of Ordnance Survey on behalf of the Controller of Her Majesty's Stationery Office © Crown copyright. Unauthorised reproduction infringes Crown copyright and may lead to prosecution or civil proceedings. Tunbridge Wells Borough Council 100024298, 2006

Highway Improvements – detail of the A264 Langton Road loading and short stay parking bays: Policy TP19(e)

Scale 1:750



Reproduced from Ordnance Survey material with the permission of Ordnance Survey on behalf of the Controller of Her Majesty's Stationery Office © Crown copyright. Unauthorised reproduction infringes Crown copyright and may lead to prosecution or civil proceedings. Tunbridge Wells Borough Council 100024298, 2006